

AS Range - Slimline Fans



AS - Toilets/Shower Rooms/Bathrooms/Utility Rooms and Kitchens

- extremely low profile
- 10cm, 12 and 15 cm sizes
- 10cm "Plus" models can be ducted up to 6m
- white or chromium
- standard, timer, humidity control and PIR
- wall, ceiling and panel
- low noise levels
- low running costs
- complies with Building Regulations Parts L1A 2013 and F 2013



AS Range - Slimline Fans

GENERAL FEATURES

- Ultra slim profiled fans
- **AS10Plus** with advanced aeraulic design for improved pressure and innovative impeller design to guarantee low noise level
- **AS10Plus** fans will extract 26 litres/sec (95m³/hr) at a pressure of 42 Pa
- for toilets, bathrooms, shower-rooms, utility rooms and kitchens
- To exhaust air and fumes directly outside or through ducting **AS10Plus** up to 6m
AS12 and AS15 up to 3m
- timer adjustable from 3 to 25 minutes
- humidity control models with:night time set back and ant-hunting device
- if using remote humidistat it must be a DRH240
- neon indicator to show when operating
- wall, ceiling or panel installation
- standard, timer, humidity control and PIR models
- easy and economical to install and maintain - easy clip-on cover
- Integral back-draught shutter
- energy saving ventilation
- **extremely low running costs**

TECHNICAL FEATURES

- shockproof, high quality technopolymer casing
- streamlined for improved air flow
- induction motor with thermal protection
- motors have sealed, self-lubricating bearings for long life
- operates in ambient temperatures up to 40°C
- double insulated - no earth required
- IPX4 Splashproof rated - can safely be installed in Zones I and II

COMPLIES WITH

- Fans comply with The Ecodesign for Energy-Related Products and Energy Information (Amendment) EU Exit) Regulations 2019; The Restriction of the Use of Certain Hazardous Substances in Electrical and Electronic Equipment Regulations 2012; Electromagnetic Compatibility Regulations 2016, Electrical Equipment (Safety) Regulations 2016
- Fans are UKCA and CE Marked
- Comply with Building Regulations Parts L1A 2013 and F 2013

Vectaire Ltd can supply all accessories for use with these units, including product filters, air filter cassettes, silencers, fire dampers, air valves, ducting, outside grilles and wall cowls. Additionally, Vectaire offers a design service to ensure that the unit installed is the best possible to provide efficient, effective, low energy and low running cost ventilation. Vectaire can also organise installation, commissioning and maintenance of these products.

Only approved accessories should be used:

Wall Plates – as required

Wall terminations – as required

TYPICAL SPECIFICATION

Supply and install an **AS10Plus** high performance axial fan for toilets, bathrooms and shower-rooms as supplied by Vectaire Ltd, Lincoln Road, Cressex Business Park, High Wycombe, Bucks, HP12 3RH.

The fan is to be for ceiling, wall or panel (with the appropriate accessories) installation, have an integral timer **and** be capable of complying with Building Regulations extract requirements when ducted up to 6 metres. There should be a neon on the front of the fan to indicate when it is operating.

The fan casing should be made of shockproof and heat resistant plastic, contain a motor with sealed, self-lubricating bearings, and be protected with a thermal cut-out.

The fan should be double insulated and be suitable for installation into Zones I and II. The fan is to be CE marked and comply with UK Building Regulations requirements..

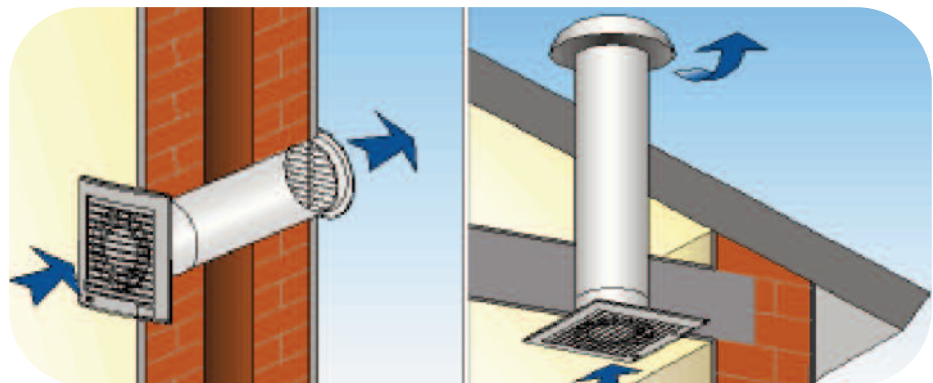

MODELS AVAILABLE: - 4"/10cm

- **AS10Plus** - standard with neon - white
- **AS10TPlus** - with overrun timer and neon - white
- **AS10HTPlus** - with humidistat, timer and neon - white
- **AS10PIRPlus** - with passive infra red sensor - white

MODELS AVAILABLE: - 5"/12cm

- **AS12** - standard models - white
- **AS12T** - with overrun timer - white
- **AS12HT** - with humidistat, timer and neon - white
- **AS12PIR** - with passive infra red sensor - white

MODELS AVAILABLE: - 6"/15cm

- **AS15** - standard models - white
- **AS15T** - with overrun timer - white
- **AS15HT** - with humidistat, timer and neon - white
- **AS15PIR** - with passive infra red sensor - white

above models (except AS 12PIR and AS15PIR) available in "Cr" - chromium - versions



AS Range - Slimline Fans

TECHNICAL CHARACTERISTICS					
Model	Airflow m ³ /hr	Airflow l/sec	Pressure - Pa	Power - Watts	dBA [@ 3m in free field]
AS10 Plus	95	26	42	14	31
AS12s	165	46	54	15	37
AS15s	295	82	71	25	44

PERFORMANCE (curves are for guidance only)

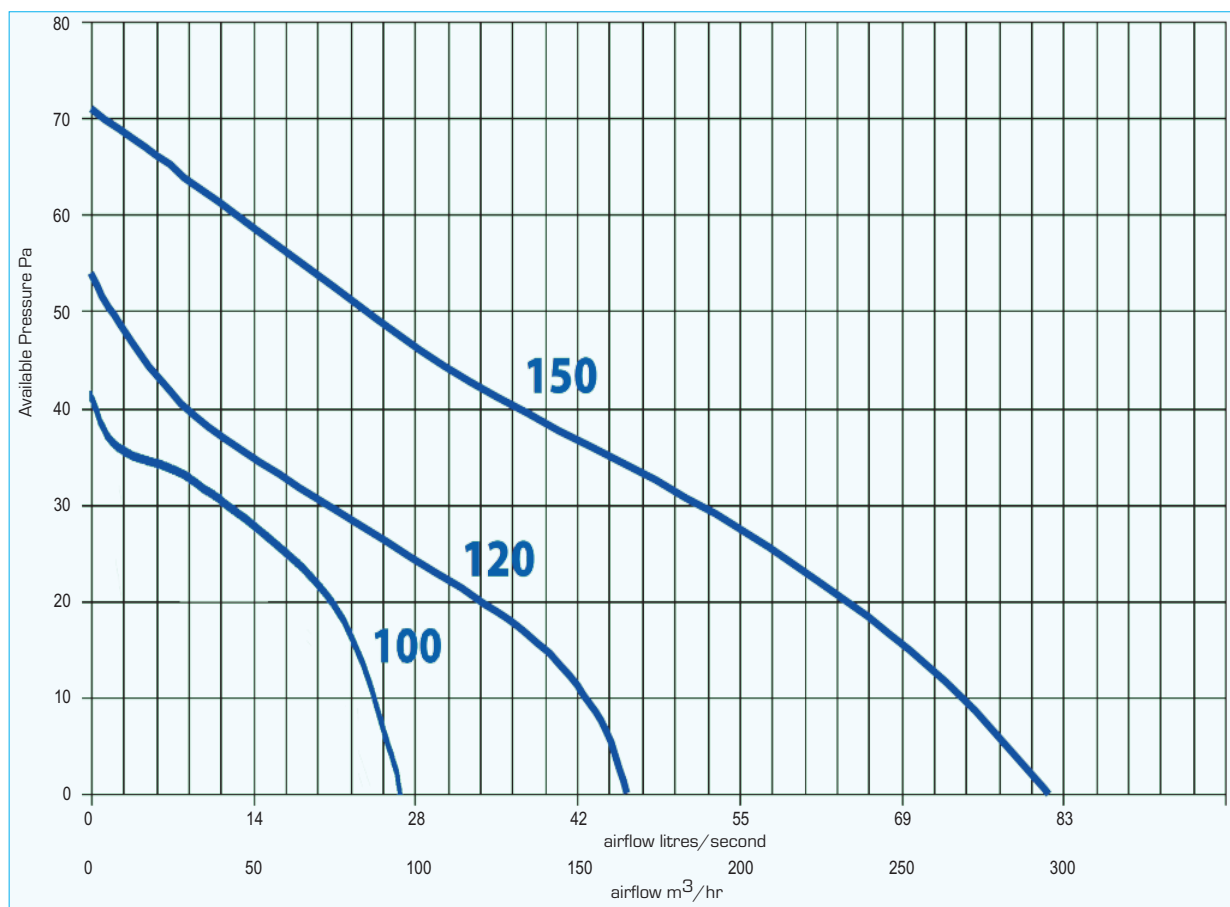

DIMENSIONS - mm

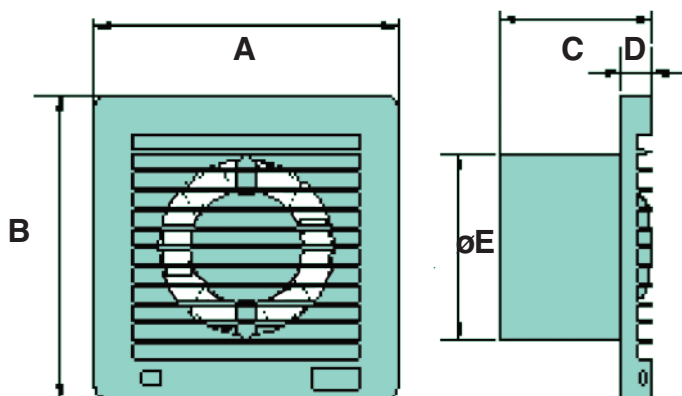

Model	AS10s	AS12s	AS15s
A	160	180	200
B	160	180	200
C	95	101	119
D	17	18	22
E	98.2	119	149
Kg	0.45	0.66	1.04